

GROUND PREPARATION (WOODEN FLOOR)

We recommend that you take a moment to read the following information attentively for a better setting of your garden shed.

CLEARING :

A minimum clearing of 28 inches all around the site of the garden shed, free of any obstacle (ex: trees, wires, etc.) leveled with the assembly site, is needed. For PVC fences and other fragile finishes, we ask a minimum of 36 inches of clearance. This clearing allows a better installation and will make the maintenance of your yard and garden shed easier.

If the clearing cannot be respected, CABANONS FONTAINE INC. will add supplementary fees.

Some municipalities ask for a larger clearing. It would be advised to communicate with your municipality to find out about their rules for the setting of a garden shed.

SITE :

When the location is defined, dig the dimension of the floor six inches deep. lay down your geotextile cloth and cover it with three inches of 0-3/4" gravel.

Level it as well as possible. This will increase the stability of the shed and allow a more efficient draining of the ground.



Cabanons Fontaine

SINCE 1976

3497, Industrie boulevard
St-Mathieu de Beloeil (Québec) J3G 4S5

(450) 536-3563

1-888-838-3563

Fax : (450) 536-2006

Technical Service ext 402

fontaine@cabanons.com

www.cabanons.com

GROUND PREPARATION (WOODEN FLOOR)

SUGGESTION

STEP 1:

Dig 6" to 8" the dimension of your garden shed
(ex: Shed 8' x 12' , Dig 8' x 12')

STEP 2:

Spread your geotextile cloth

STEP 3:

Cover the surface of 3" to 5" of gravel 0-3/4"
(ex: If you dig 6" , put 3" of gravel)

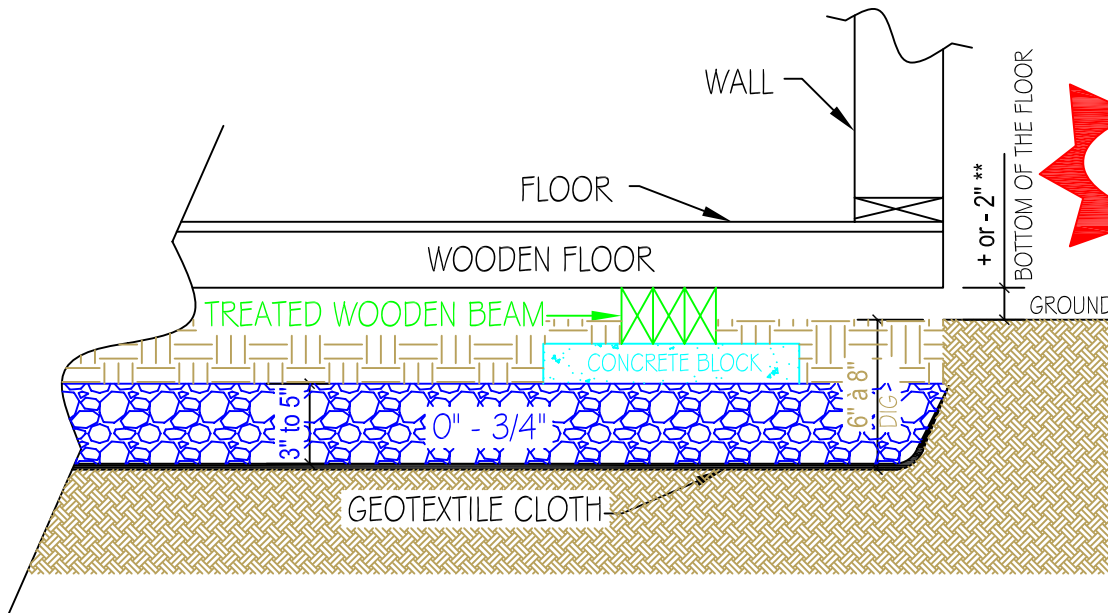

You need to keep a space of 28" free of obstacles and leveled for the perimeter of the garden shed.

GROUND SECTION (Ground preparation)

** We suggest that the bottom (stocking) of your floor is in + or - 2 " above the ground level, so allowing a good aeration. (Allows the humidity to evacuate)

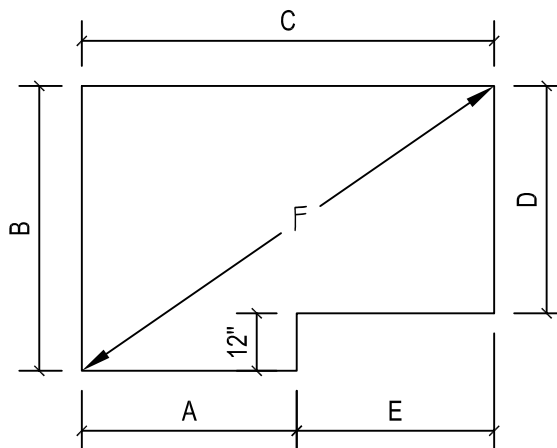
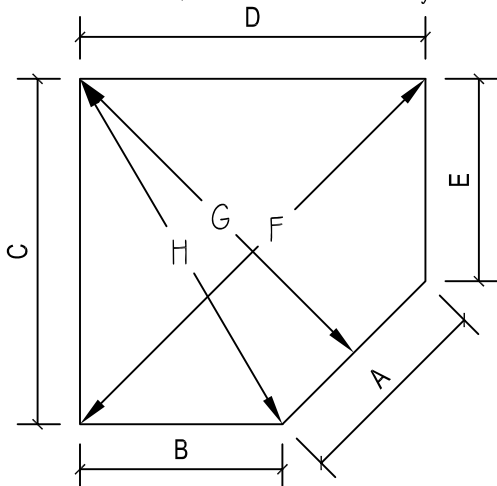

A =
B =
C =
D =
E =
F =
G =
H =