

# GROUND PREPARATION (CONCRETE FLOOR) GARAGE (SUGGESTION)

*We recommend that you take a moment to read the following information attentively for a better setting of your garden shed.*

## CLEARING :

A minimum clearing of 36 inches (3ft) all around the site of the garage, free of any obstacle (ex: trees, wires, etc.) leveled with the assembly site, is needed. For PVC fences and other fragile finishes, we ask a minimum of 60 inches (5ft) of clearance. This clearing allows a better installation and will make the maintenance of your yard and garden shed easier.

If the clearing cannot be respected, CABANONS FONTAINE INC. will add supplementary fees.

Some municipalities ask for a larger clearing. It would be advised to communicate with your municipality to find out about their rules for the setting of a garage.



# Cabanons Fontaine

SINCE 1976

3497, Industrie boulevard  
St-Mathieu de Beloeil (Québec) J3G 4S5

(450) 536-3563

1-888-838-3563

Fax : (450) 536-2006

Technical Service ext 402

fontaine@cabanons.com

www.cabanons.com

# GROUND PREPARATION (CONCRETE FLOOR)

GARAGE (SUGGESTION)

- STEP 1: Dig 20" to 24" the dimension of your garage  
( ex: garage 22' x 28' , dig 22' x 28' )
- STEP 2: Cover the surface of 12" to 16" of gravel 0-3/4" well compacted
- STEP 3: Spread a polyethylene
- STEP 4: Instal a 2" rigid insulation type 4
- STEP 5: Make a concrete slab between 5" to 8" thickness with rods and wire mesh 6" x 6"

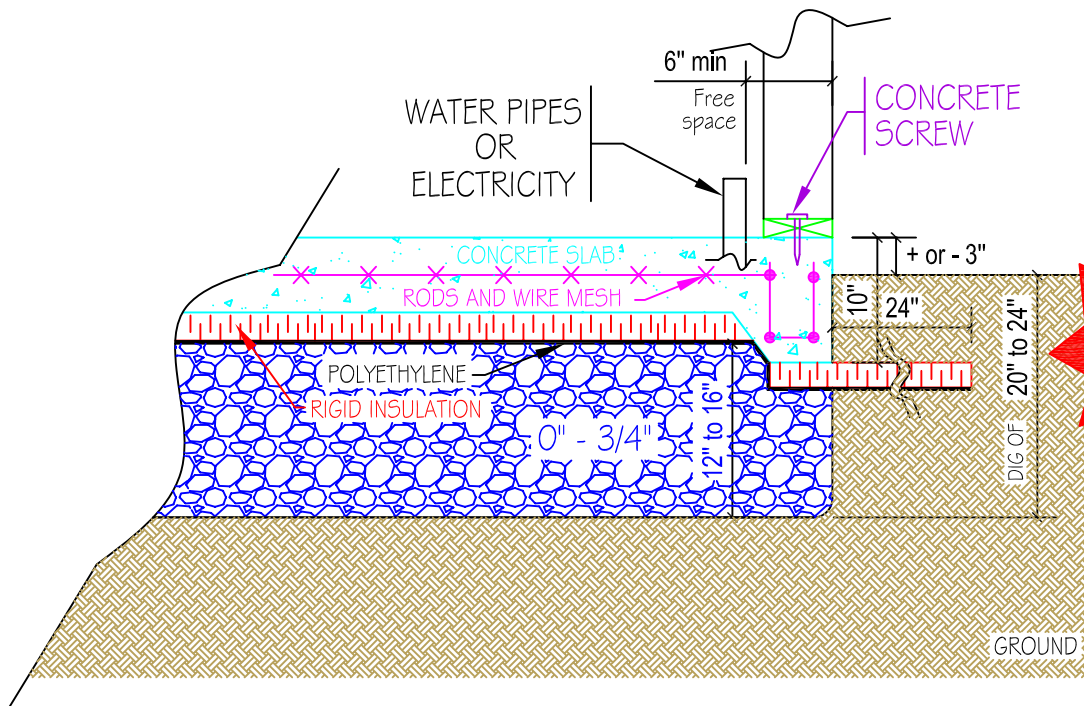

- NOTE :
- The rod should be at 4" from the side of the concrete floor.
  - Electric pipes should be at least 6" from the side of the concrete floor.
  - For special walls ( brick, stone ) place the pipe at least 8" from the side of the concrete floor.
  - All work related to the concrete slab is the responsibility of the customer.

**IMPORTANT : THE CONCRETE FLOOR SHOULD BE LEVELED AND SQUARE.**